

# Anterior Nasal Specimen Collection for SARS-CoV-2 Test using PrimeStore® MTM or Aptima™ Swab

## 1

- Assemble the supplies needed. For sample collection, have the swab, collection vial, specimen label, and biohazard bag available.
- If the patient has a lot of mucus in the nose, this can interfere with collection. Have the patient use a tissue to gently clean the nasal passage before a swab is taken.

## 2



- Open the swab container and remove the swab, taking care not to touch the tip to any surface or lay it down.

## 3

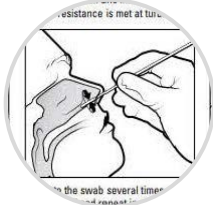

- Gently insert swab at least 1 cm (0.5 inch) into the nostril.
- Firmly sample the nasal membrane by rotating the swab and leaving in place for 10 to 15 seconds. Sample both nostrils with the same swab.

## 4

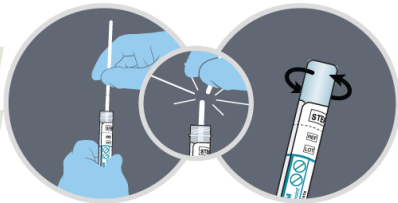

- Place swab into the collection vial and break (snap) off swab at the indicator line. Replace cap and screw cap on securely.

## 5

- Label the transport tube with patient's name, date of birth, physician's name and specimen collection date. Affix the label to the tube, and place in a biohazard bag.
- Complete the COVID-19 test requisition in full and check all applicable boxes in the Clinical Information section. **Note that the patient information section must be completed in full to process testing and report results to clients and the CDC.** Fold and place the completed requisition in the side pocket of the biohazard bag.

## 6

- To prepare for shipment, place all specimen bags into a large biohazard bag and seal. Then place the large biohazard bag into a Poplar Healthcare white specimen box to ensure the specimen vials are protected during shipment.
- Slide the white specimen transport box into a FedEx Clinical Pak and affix an overnight FedEx Airbill. Please ship specimens promptly to ensure timely processing and specimen viability. **Note that COVID-19 samples must be shipped separately from all other specimen types.**



\*Exact manufacturer of the swab and transport media may vary with supply.